

**objectivecapital**

# Global Mining

Investment Conferences



# GLOBAL MINING INVESTMENT CONFERENCES

Tuesday - Wednesday, 28-29 September 2010

Stationers' Hall, City of London

---

# Global Mining Investment Conference

Tuesday - Wednesday, 28-29 September 2010 | 8:30am – 9:00pm

---

Objective Capital's Global Mining Investment Conference brings together providers of capital with an exclusive selection of current and future commodities producers in the heart of the world's financial system.

Our Global Mining series of investment conferences concentrate on the metals, minerals and energy sectors: high value, capital-intensive businesses which require large scale funding. Both sides of the equation are looking for new opportunities for funding and quality deals. Whether you are a metals, minerals or energy company, the Objective Capital Global Mining Investment Conferences are an opportunity you should not miss.

These engaging conferences are also a must attend for anyone with a serious interest in investing in the sector – whether they be family offices, fund managers, investment bankers, venture capitalists or high net worth individuals.

The event's dynamic 'non-duplication' format of presentations interspersed with guest speakers focuses predominantly on the global marketplace. The intense programme is provided by world-class speakers from global companies to bring you up-to-date with the latest developments in precious and base metals, diamonds, mineable energy products and bulk commodities. ***Who better to discuss the global outlook for commodities than the very companies exploring and extracting them!***

The Objective Capital Global Mining Conferences are split throughout the day with generous allowance for all important networking opportunities. The exhibition areas also house several booths and provide for further networking and business opportunities.

## Who should attend?

- Fund managers
- Investment bankers
- Senior executives of resource companies
- Investor relations
- Private investors
- Venture capitalists
- Brokers
- Analysts

Attendance is free **by invitation only**. To request an invitation, please email [gabriel@objectivecapital.com](mailto:gabriel@objectivecapital.com)

# Global Mining Investment Conference

Tuesday - Wednesday, 28-29 September 2010 | 8:30am – 9:00pm



## CONFERENCE PROGRAMME

### Tuesday, 28 Sep 2010

08.30 - 09.30 *Registration and Coffee*

09.30 - 09.55 **Opening Keynote: A view from the majors**

#### **Session 1** Outlook for precious metals

09.55 - 10.20 Gold

10.20 - 10.45 Silver

10.45 - 11.10 PGMs

11.10 - 11.30 *Coffee & Networking*

11.30 - 11.55 **Presentation by Principal Sponsor**

#### **Session 2** Outlook for speciality and minor metals

11.55 - 12.20 Speciality/Minor Metal 1

12.20 - 12.45 Speciality/Minor Metal 2

12.45 - 1.10 Speciality/Minor Metal 3

1.10 - 2.00 *Networking Lunch*

2.00 - 2.25 **Afternoon Guest Speaker:**

#### **Session 3** Industrial minerals & metals and mineable energy

2.25 - 2.50 Presentation 1

2.50 - 3.10 Presentation 2

3.10 - 3.45 Presentation 3

3.45 - 4.00 *Coffee & Networking*

4.00 - 4.25 Presentation by Principal Sponsor

#### **Session 4** Base metals

4.25 - 4.50 Base Metal Presentation 1

4.50 - 5.15 Base Metal Presentation 2

5.15 - 5.45 **Closing Keynote: A Fund Manager's**

5.45 - 9.00 *Closing Drinks and Networking*

### Wednesday, 29 Sep 2010

08.30 - 09.30 *Registration and Coffee*

09.30 - 09.55 **Opening Keynote: A view from the majors**

#### **Session 1** Opportunities and challenges in Asia Pacific's hotspots

09.55 - 10.20 China

10.20 - 10.45 Australia

10.45 - 11.10 Asia Pacific Hotspot 3

11.10 - 11.30 *Coffee & Networking*

11.30 - 11.55 **Presentation by Principal Sponsor**

#### **Session 2** Opportunities and challenges in The Americas' hotspots

11.55 - 12.20 Canada

12.20 - 12.45 Americas Hotspot 2

12.45 - 1.10 Americas Hotspot 3

1.10 - 2.00 *Networking Lunch*

2.00 - 2.25 **Afternoon Guest Speaker:**

#### **Session 3** Opportunities and challenges in Africa's hotspots

2.25 - 2.50 South Africa

2.50 - 3.10 Africa Hotspot 2

3.10 - 3.45 Africa Hotspot 3

3.45 - 4.00 *Coffee & Networking*

4.00 - 4.25 Presentation by Principal Sponsor

#### **Session 4** Opportunities and challenges in Europe's hotspots

4.25 - 4.50 Europe Hotspot 1

4.50 - 5.15 Europe Hotspot 2

5.15 - 5.45 **Closing Keynote: A Fund Manager's**

5.45 - 9.00 *Closing Drinks and Networking*

# Global Mining Investment Conference

Tuesday - Wednesday, 28-29 September 2010 | 8:30am – 9:00pm

**For all information on exhibition and advertising packages, please contact the Programme Director, Ros Lund:**

**T:** +44 (0)207 073 2944

**F:** +44 (0)203 137 0076

**US Toll-free:** 1-888 802 7215

**E:** [ros@objectivecapitalconferences.com](mailto:ros@objectivecapitalconferences.com)

**W:** [www.objectivecapitalconferences.com](http://www.objectivecapitalconferences.com)

Exhibit at the conference to achieve maximum visibility and attention among your prospective clients and future partners.

The exhibition is situated on the ground floor. Exhibition opening hours:

**Tuesday - Wednesday, 28-29 Sept: 09.00-17.00**

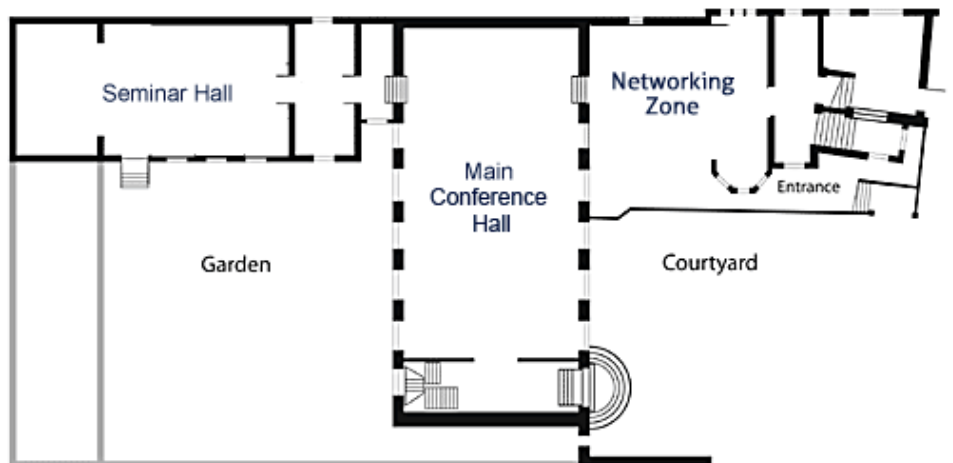

## Directions to Stationers' Hall

Stationers' Hall is located at the top of Ludgate Hill, off Ave Maria Lane, just opposite St Paul's Cathedral.

- Tube  
Nearest tube stations: St Paul's, approximately 3 minutes walk (Central Line); Blackfriars (District and Circle Line), approximately 10 minutes walk. (detailed instructions below)
- Railway  
Nearest mainline railway stations: Cannon Street (operating during rush hour only, approximately 15 minutes walk); City Thameslink (station on Ludgate Hill, approximately 4 minutes walk).
- Taxi  
A taxi rank is located outside the main steps of St Paul's Cathedral on Ludgate Hill.
- Bus  
Bus routes stopping on Ludgate Hill are Numbers 4, 11, 15, 17, 23, 26, 76, 100, 172.

## From St Paul's Tube (Central Line)

Exit the station at the right hand exit. Walk left along Newgate Street. Turn left into Warwick Lane. Warwick Lane becomes Ave Maria Lane. Turn into the Courtyard on the right at Vidal Sassoon. Come down the stairs and into the Hall.

## From Blackfriars Tube (District & Circle)

Exit onto Queen Victoria Street and turn right onto New Bridge Street (towards Holborn). Continue to Ludgate Circus (cross roads). Turn right onto Ludgate Hill with St Paul's Cathedral ahead. On left hand side is a Starbucks & Links shop. Between them is an alleyway signposted Stationers' Hall. This leads you to the Courtyard, enter the Hall down the steps ahead.

## From Bank Tube

(Waterloo & City, Northern, Central, DLR)

Exit onto Cheapside, towards St Paul's. Continue along Cheapside until you get to St Paul's Tube. Carry on ahead onto Newgate Street (*see above*).

For all information on exhibition and advertising packages, please contact **Gabriel Didham**, Managing Director:

**T:** +44 (0)207 073 2944

**M:** +44 (0)79 81195392

**E:** [gabriel@objectivecapitalconferences.com](mailto:gabriel@objectivecapitalconferences.com)

or our Programme Director, **Ros Lund** on:

**T:** +44 (0)207 073 2944

**F:** +44 (0)203 137 0076

**US Toll-free:** 1-888 802 7215

**E:** [ros@objectivecapitalconferences.com](mailto:ros@objectivecapitalconferences.com)

**W:** [www.objectivecapitalconferences.com](http://www.objectivecapitalconferences.com)

## Conference Information

### Accommodation

Delegates are responsible for organising their own travel and accommodation. Details of specially negotiated hotel deals will be posted on [www.objectivecapitalconferences.com](http://www.objectivecapitalconferences.com) when available.

### The venue

Stationers' Hall is located at the top of Ludgate Hill, off Ave Maria Lane, just opposite St Paul's Cathedral.

Stationers Hall  
Stationers Hall Ct  
Ave Maria Ln, City of London  
Greater London EC4M  
Tel: 020 7403 3300, UK  
[www.stationers.org](http://www.stationers.org)

### Conference fees

The conference fee includes attendance at the conference and exhibition, conference proceedings on CD, conference and exhibition handbook, conference briefcase, lunches, welcome and farewell receptions.

### Registration fee discounts

Objective Capital offers a 10% discount for third and subsequent delegates from the same company.

### Cancellations

Cancellations will be accepted and delegates may receive an 80% refund of fees paid up to 1 September 2010. No refunds will be made for cancellations after this date. Substitutions from the same company can be made at no cost up to 1 September 2010.

### About the organiser

Objective Capital is a dedicated corporate research firm providing institutional-quality research on under-followed small and mid cap companies.

Unlike other providers, we focus entirely on providing widely distributed research coverage of our sponsored companies. Our programme of high quality, objective corporate research allows quoted companies to ensure that there is always an informed market in their stock.

# Request more information

## Global Mining Investment Conference

Tuesday - Wednesday, 28-29 September 2010 | 8:30am – 9:00pm

### Please send me further information on

- Presenting my company in the heart of the world's financial system at the Objective Capital Global Mining Investment Conference in London
- Exhibiting my company at the Objective Capital Global Mining Investment Conference in London
- Attending the event as an invited guest

Company Name \_\_\_\_\_

Address \_\_\_\_\_ City \_\_\_\_\_

State/Province \_\_\_\_\_

Country \_\_\_\_\_ ZIP/Post Code \_\_\_\_\_

Contact Name \_\_\_\_\_ Telephone Number \_\_\_\_\_

Email Address (required) \_\_\_\_\_

Signed by \_\_\_\_\_

On behalf of \_\_\_\_\_

Date \_\_\_\_\_